

RACKLESS

Awning Mount System

Important:

Installation should only be done by a qualified person and it is the responsibility of said person to ensure correct fitment.

Please read all procedures and precautions before installing and using the Rackless Awning Mount System. If you have any questions please contact us via email on the back of this installation manual.

Warning!

Please follow these steps when drilling the roof to avoid damage to the side curtain airbag mechanism. Failure to follow these steps will result in vehicle damage. It is recommended the vehicle roof head lining should be removed to ensure nothing is below the drilled position.

Information:

For individual vehicle specifications & terms and conditions refer to page 4 of these instructions.

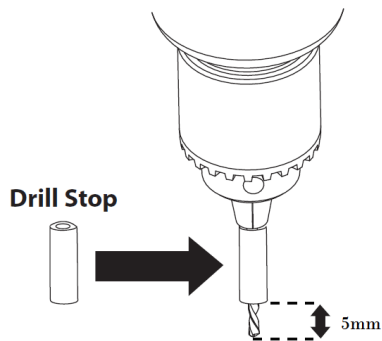

Warning!

Max Drill Depth is 5mm

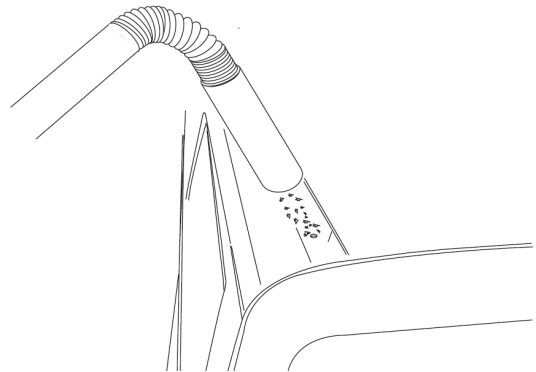

Drill approximately halfway and then use a vacuum to remove swarf from roof channel. Continue drilling the hole, repeat operation for remaining holes.

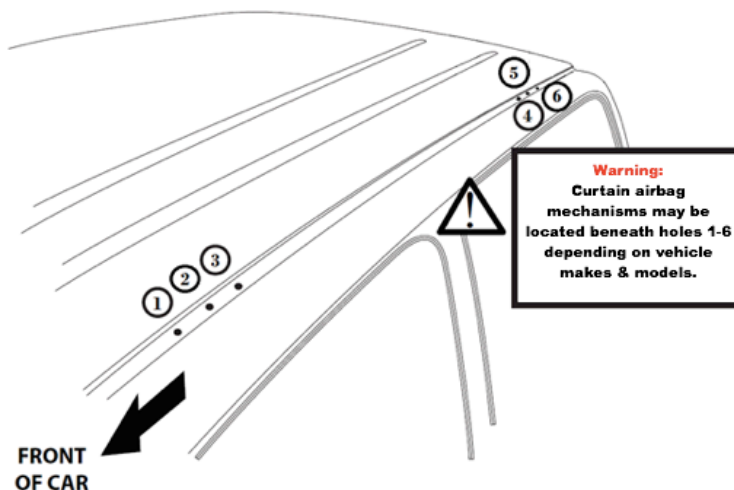

Care Instructions:

Clean vehicle roof before fitting Rackless roof mounts.

Tools Required:

- Vacuum cleaner
- 5mm drill bit with depth stop
- Marking pen
- Rivet gun with head to fit inside 12mm counter sunk hole
- Cordless or power drill
- Hammer and centre punch
- Rust stop paint and brush
- T30 torx security socket bit and torque driver
- Silicon and caulking gun
- Measuring tape
- Tin snips
- Tape

- Flat blade screwdriver

Kit Contents:

- 2x Rackless bracket assemblies
- 4x T30 Stainless security bolts
- 4x Stainless washers
- 2x Paint protection strips
- 1x T30 torx bit

Optional Kit Extras:

- 2x Stainless roof mounts
- 6x Stainless pop-rivets

Fitment Instructions:

Note: Please skip steps 1-10 if your vehicle has pre-existing roof tracks.

1. Before installation check bracket and mount application is compatible with your vehicle.
2. Wrap tape around a flat blade screw driver to prevent paint scratching then gently lever the rubber trim from the roof gutter then using fingers carefully pull upwards. Small plastic clips are attached to the roof underneath each end of the strip.

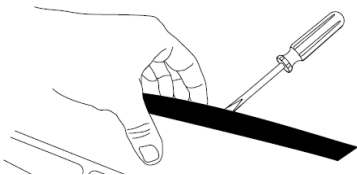

Note: Some makes & models have double sided tape applied so be sure not to kink the rubber when removing.

3. Place the mount in the channel and measure from the edge of the windscreen rubber to the front of the mount. The use of masking tape will help maintain this measurement while marking out holes for drilling. Mark the holes 1 using a marking pen, remove the mount. Do the same for the rear mount. See measurements guide on page 4 of these instructions.

Note: Purpose of extra holes on one roof mount is for fitment of optional LED light bar and should be placed facing the front of the

vehicle.

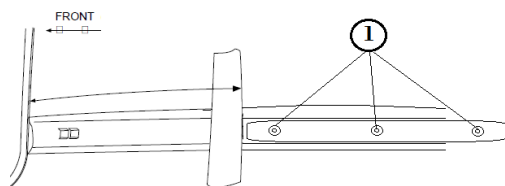

4. Accurately centre punch all holes before drilling.



5. Marked out holes can now be drilled using a 5mm drill bit with a drill stop. Set up the drill stop ensuring you don't drill through the roof lining.

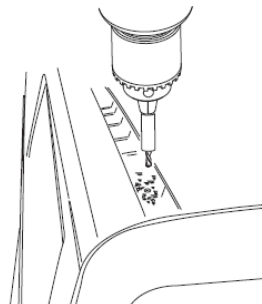

NOTE:
USE CARE WHEN BREAKING THROUGH. A DRILL STOP IS RECOMMENDED.

6. Use a vacuum to remove swarf from the roof channel.

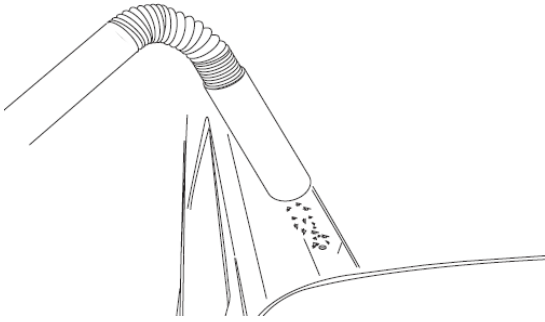

7. Apply anti rust paint to the inside and surrounds of all holes, allow for time to dry before applying silicon around each hole.

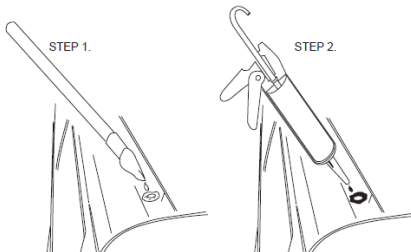

8. Accurately place the mount over the drilled holes in the roof channel using the rivets to position.

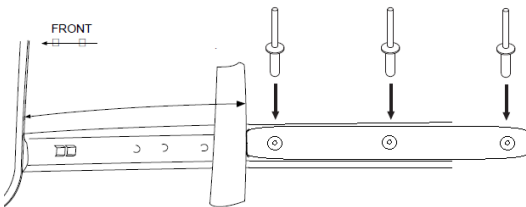

9. Using rivet gun, rivet the mount into place, make sure all rivets are seated firmly onto the base of the mount.

Note: Once pop rivets are fitted counter bore can be filled with silicon to prevent from holding water.

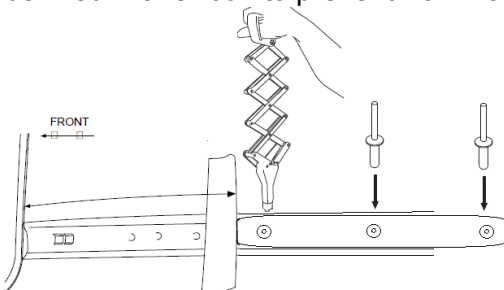

10. Measure and cut the rubber roof trim with tin snips and put back in the vehicle roof channel at the front, middle and rear of the tracks, the front piece needs to be measured so the end of the trim sits under the windscreen rubber.

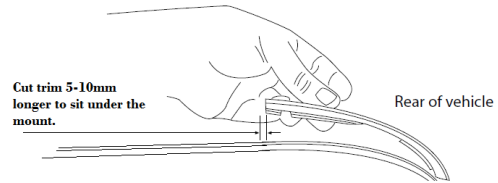

Note: The measurement and cutting of the rubber should be cut with an extra 5-10mm as the end of the mount will cover it. A small amount of silicon can be used to help hold in place.

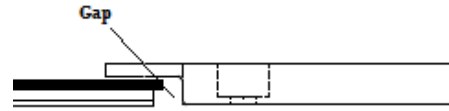

11. Apply paint protection strip to sit directly beneath both Rackless awning mounts.
12. Rackless awning mounts to be fitted to the roof gutter and mounts of the car with 4x M6 bolts and washers using an Anti-theft torx bit. Tighten bolts evenly to a torque of 5 Nm.

Note: This will be the same method if being fitted to roof tracks.

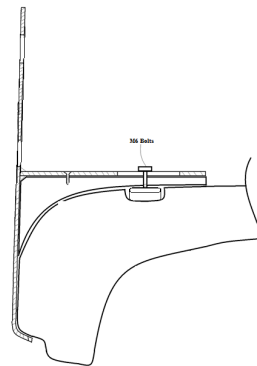

13. Fit awning to awning mount using the bolts provided with awning and tighten to specs within awning instructions.

Note: Some mounts have differing bolt lengths, ensure there is a significant amount of bolt through the mount.

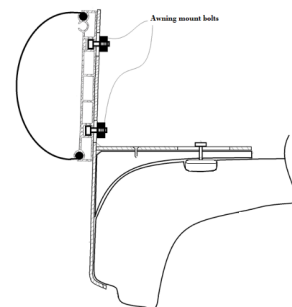

Maintenance recommendations:

It is essential that all bolts and connections be checked after driving a short distance when you first install your awning mounts.

All bolt connections should be checked again at regular intervals (more often on rough road conditions). Ensure bolts are to specified torque as per above installation instructions.

The high density foam and paint protection strips should be inspected at regular intervals and replaced when required as these materials will not outlast the lifetime of the mounts. Please contact us if you require material replacements.

Sensitivity to cross winds and behaviour in curves:

The handling characteristics of the vehicle changes with the wind drag of an awning, for safety reasons we recommend you exercise extreme care when driving.

Please remove awning and brackets when putting vehicle through an automatic car wash.

Note to Dealers and Fitters:

It is your responsibility to ensure instructions are given to the end user or client.

Note:

No responsibility or liability will be held against supplier for incorrect fitment of product resulting in component or vehicular failure or damage. By purchasing this product you agree to all of these conditions.

Vehicle Make & Model	Front Mount 1 st hole from Windscreen	Rear Mount 1 st hole from Windscreen
Toyota Hilux N70	240mm	1140mm
Isuzu D-Max	280mm	1200mm
Holden Colorado RG	280mm	1200mm

Chalming Creations will provide warranty to the original purchaser and only the original purchaser of the Rackless product under the following conditions;

- Chalming Creations will warrant against manufacturing faults and defects in material for a period of 12 months from original purchase date.
- To obtain warranty, Chalming Creations must be provided with proof of purchase. This warranty does not cover the removal or re-installation of the product.
- To obtain warranty, Chalming Creations must be provided with proof of fitment by a qualified person.
- Chalming Creations reserves the right, at its option, to repair, replace or refund the purchase price of a faulty or defective product or its components if returned to the place of purchase during the warranty period.
- When returning a product for warranty assessment it must be accompanied with the customer's name, address, contact phone number, a clear description of the fault and a copy of the original sales receipt detailing the date of purchase.
- This warranty does not apply to damage due to accident, misuse, abuse, misapplication, collision, modification, improper installation or improper maintenance.

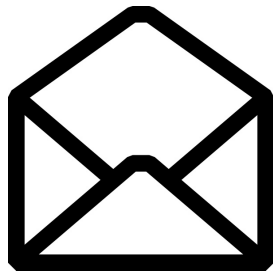

We appreciate any and all feedback. Write to us rackless.ams@outlook.com.au or rate 5 stars on Facebook and our website

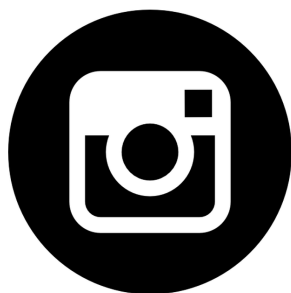

Share your rig with us on Instagram by tagging [@rackless.ams](https://www.instagram.com/rackless.ams) and [#rackless](https://www.instagram.com/explore/tags/rackless)

PO Box 1543,
Midland DC WA 6936
Australia
rackless.ams@outlook.com.au